



# LF-10 NEO

## Main Features

- **Compact and powerful design**
- **Best power to weight ratio of its class**
- **Proven technology**
- **Extremely robust GHH frame and system design** resulting in lowest operating cost
- **Z-link optimized for loading of dump trucks**
- **Customized buckets with GET**
- **Ergonomic ROPS/FOPS safety cabin with large legroom, excellent visibility and intuitive controls**
- **All daily maintenance points from ground level**
- **Centralized service points**
- **Ride control, payload weighing system and bucket shaker**

# Technical Specification

## MAIN DIMENSIONS

Length (tramming position)	9 697 mm
Length (loading position)	9 868 mm
Width (at cabin)	2 675 mm
Width (at drive unit)	2 500 mm
Width (at bucket, no GET)	2 500 mm
Height, laden (above drive unit)	1 932 mm
Height, laden (above driver's canopy)	2 350 mm
Max. tipping height	2 481 mm
Bucket capacity (SAE, heaped)	4.6 m <sup>3</sup>

## ENGINE

Manufacturer	Mercedes
Type	OM 936 (EPA Tier 3 / EU Stage IIIA)
Design	Water cooled diesel engine
Power	240 kW / 2200 rpm
Air intake system	Dry air filter
Exhaust system	Catalyst, silencer
Starter power / voltage	7.0 kW / 24 V
Alternator current / voltage	110 A / 28 V



## DRIVE TRAIN

### Transmission

Manufacturer	Dana
Type	36 000
Design	Single stage converter with lock-up Four gears forward / reverse

### Upbox

Manufacturer	Rögelberg
--------------	-----------

## ELECTRICAL EQUIPMENT

Operating voltage	24 V
Battery	2 x 12 V / 180 Ah

## WEIGHTS

Operating weight	28 200 kg
Payload capacity	10 000 kg
Front axle, empty	11 568 kg
Rear axle, empty	16 632 kg
Front axle, loaded	26 915 kg
Rear axle, loaded	11 285 kg

## WHEELS AND TIRES

### Front wheels

Rim size	13.00 - 25 / 2.5
Tire size	18 x 25
Tire pressure	7.0 ± 0.1 bar

### Rear wheels

Rim size	13.00 - 25 / 2.5
Tire size	18 x 25

## BRAKES (SERVICE AND PARKING)

Design	Multi disk spring brake (SAHR)
--------	--------------------------------

## AXLES

<b>Front axle</b>	Rigid planetary axle
Manufacturer	Kessler
Type	D102
Differential	Lim. Slip
<b>Rear axle</b>	Rigid planetary axle
Manufacturer	Kessler
Type	D102
Differential	Lim. Slip
Oscillating angle	±8°



## LIGHTING SYSTEM

Main / reverse headlights	LED
Additional headlights and position lights	LED





### DUMP / HOIST HYDRAULIC SYSTEM

System pressure	250 bar
Number of hoist cylinders	2
Number of dump cylinders	1
Boom raising time	6.6 s
Boom lowering time	4.1 s
Tipping time	2.6 s

### STEERING HYDRAULIC SYSTEM

System pressure	250 bar
Number of steering cylinders	2

### FILLING VOLUMES

Fuel tank	410 l
Hydraulic tank	200 l

### STEERING

Design	Hydraulic articulated power steering
Steering angle	± 42.5°



### TRAMMING CAPACITIES

Max. tramming speeds (laden fwd/rev, on level road)	
1st gear	5.5 km/h
2nd gear	10 km/h
3rd gear	18 km/h
4th gear	32 km/h
Maximum admissible gradient	25%
Breakout force (lift)	20 394 kg
Breakout force (tilt)	19 472 kg

### MAIN OPTIONS

Closed Cabin	Mercedes OM936LA (EU Stage V engine)
Air conditioning/heating	Emergency steering pump
Fire suppression systems (manual / auto) Ansul / Protecfire with automatic engine shut down	Electric brake release pump
Spare wheel	Manual / electric filling pump for hydraulic oil
Different bucket sizes	Tire pressure monitoring
Ejector bucket	Remote Monitoring System (WiFi-link)
Camera system	Corrosion protection kit
Ground engagement tools (G.E.T)	Low temperature kit
Payload weighing system	Radio remote control
Bucket shaker	Brake release tow hook
Ride control system	Disassembly for shaft transport
Central lubrication system	Automation ready
Collision avoidance system interface	

\* Please note that machine specifications and dimensions may change without prior notice.

## Gradeability Diagram

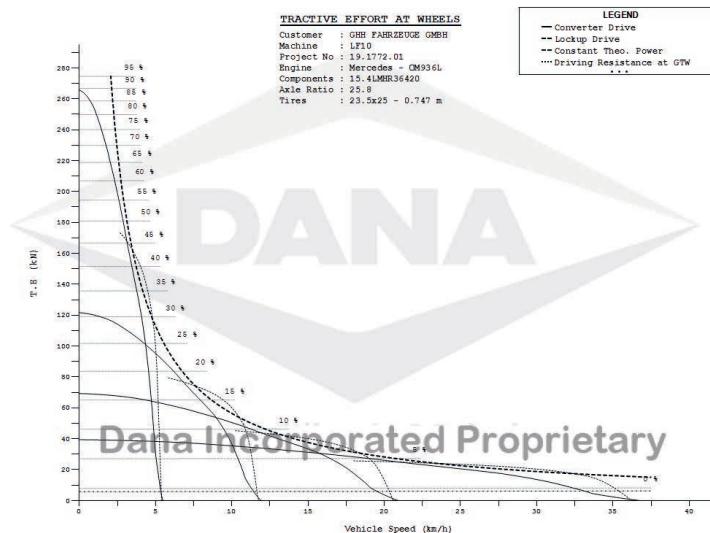

# Side View

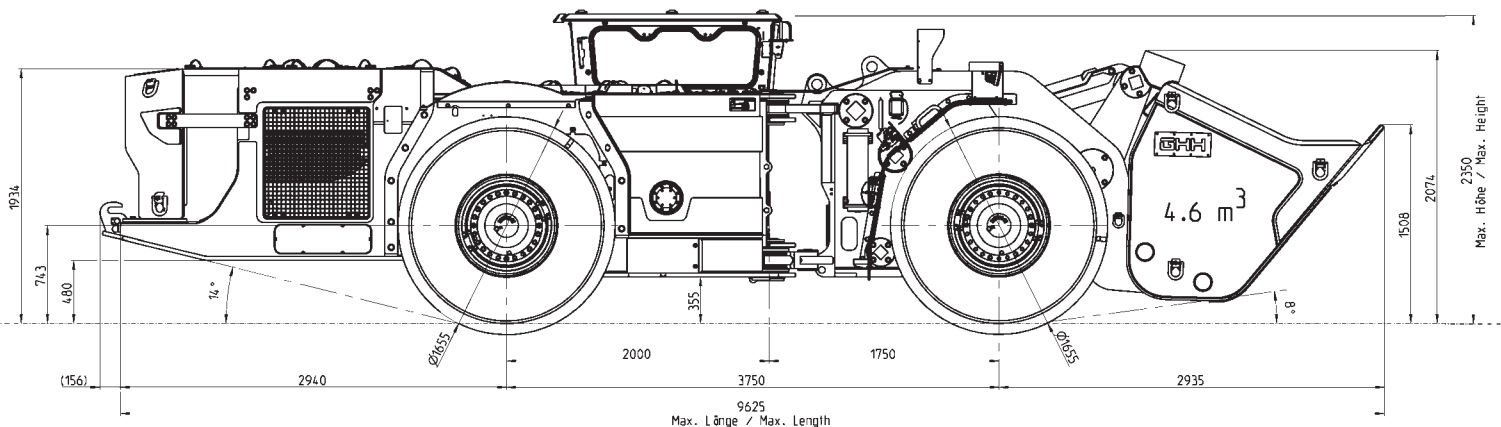

BELADEN  
RAISED TIPPING  
1:25

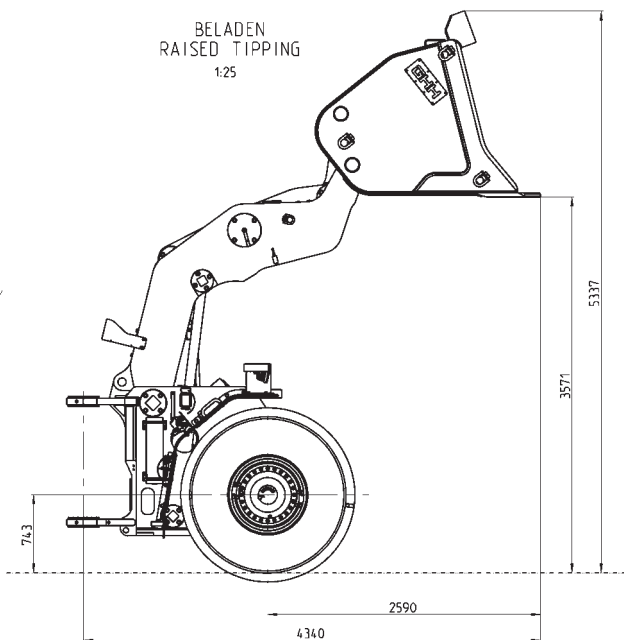

AUSKIPPEN  
TIP OUT  
1:25

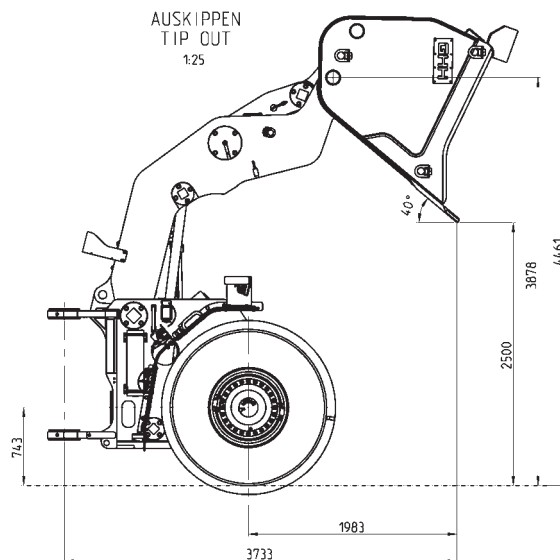

# Top View

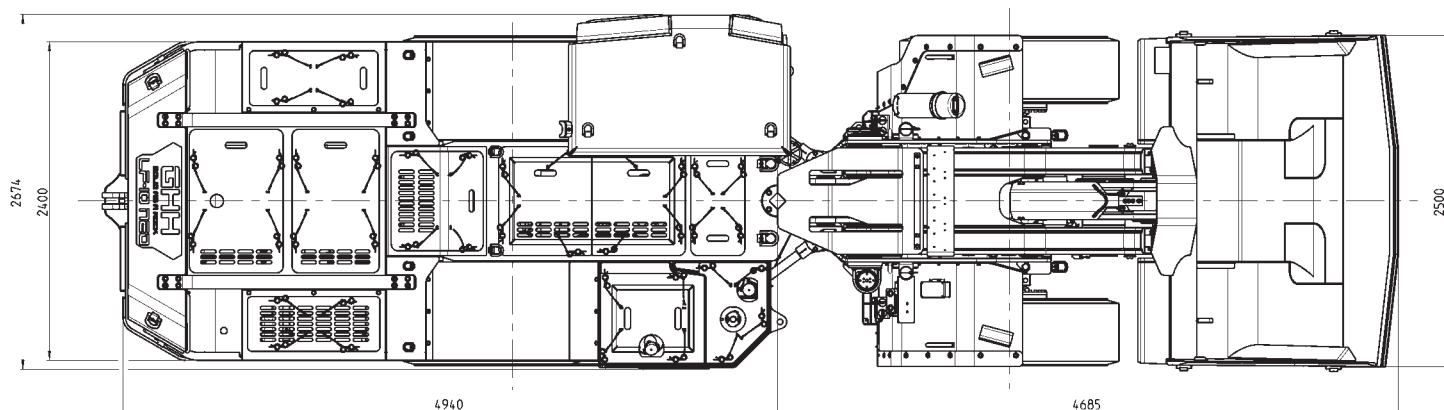

# Right Turn

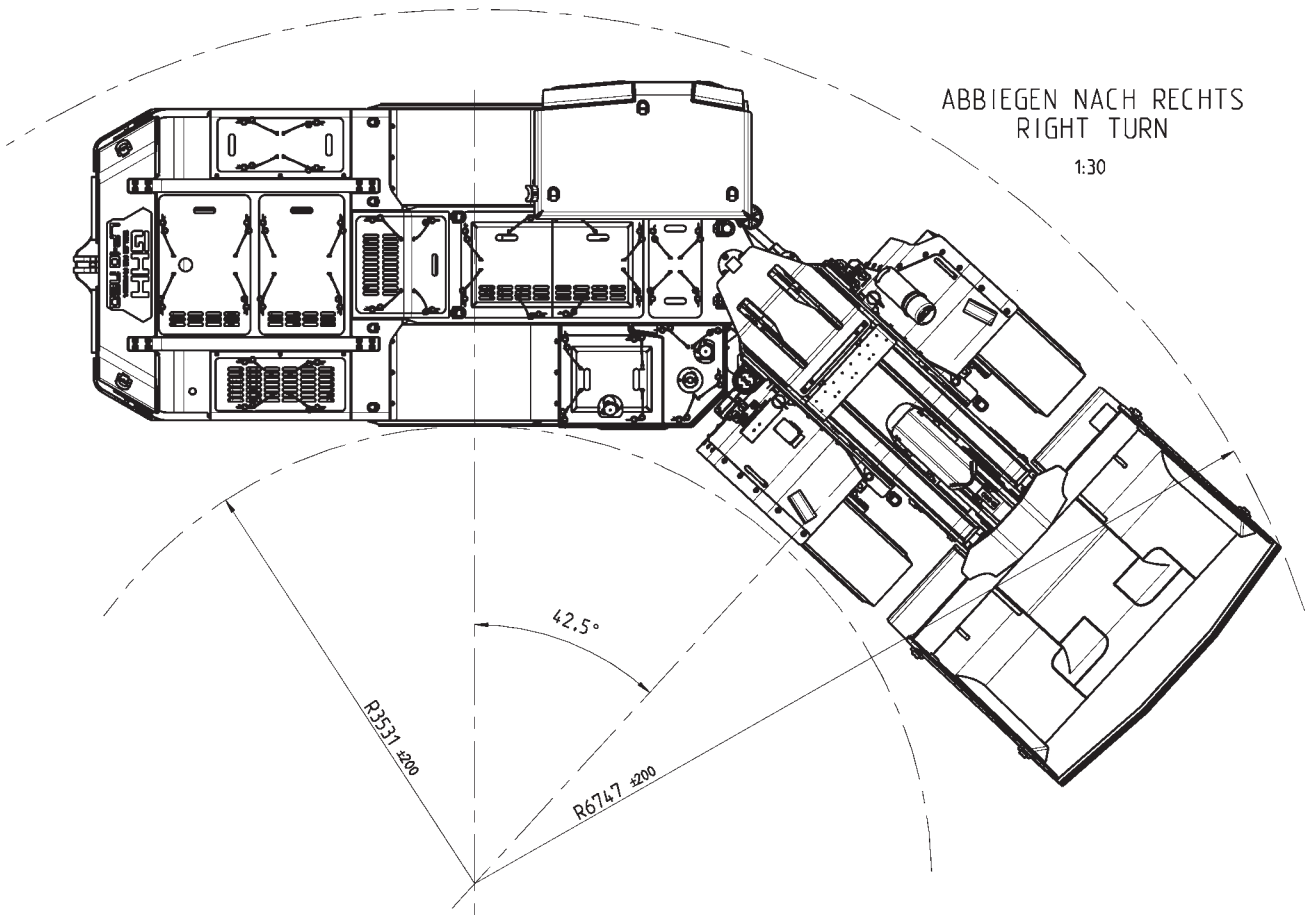

# Left Turn

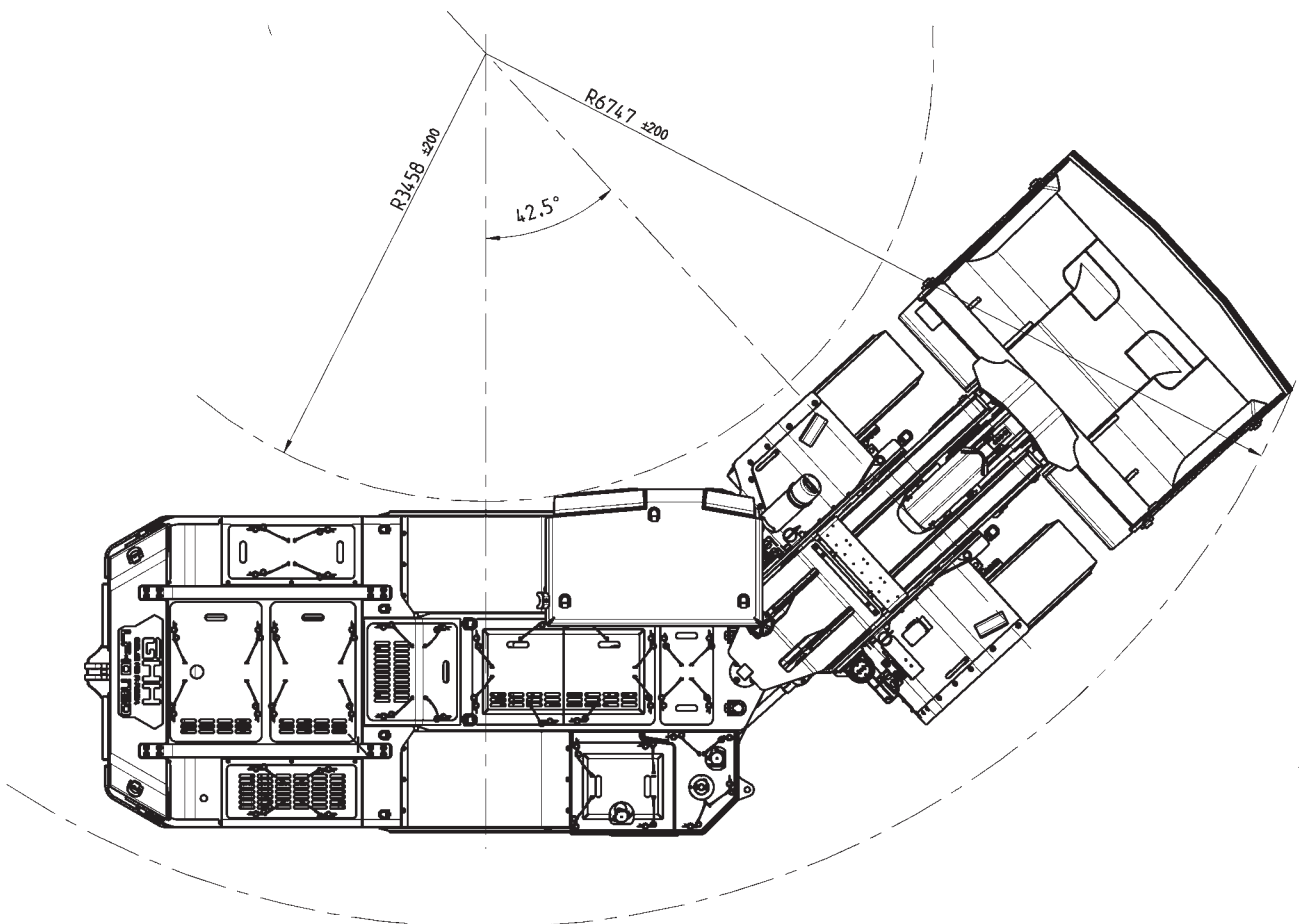



# GHH

SOLID AS A ROCK

GHH Fahrzeuge GmbH  
Emscherstr. 53  
45891 Gelsenkirchen

Tel: +49 (0) 209 38907-0  
Fax: +49 (0) 209 38907-109

E-Mail: [info@ghhrocks.com](mailto:info@ghhrocks.com)  
Web: [www.ghhrocks.com](http://www.ghhrocks.com)

GHH Mining Machines Ltd  
92 Kirschner Road, Beyers Park  
Boksburg, 1459

Tel +27 11 896 0600  
Fax +27 11 896 0605

E-mail: [sales@ghhmm.co.za](mailto:sales@ghhmm.co.za), [info@ghhmm.co.za](mailto:info@ghhmm.co.za)  
Web: [www.ghhmm.co.za](http://www.ghhmm.co.za)